















Plan de Composition

"Lotissement Le Grand Jardin"

LÉGENDE

-  Borne
-  Spit, marque de peinture
-  Regard Eaux Usées
-   Mur Technique
-  Rang d'Agglo / Bordure
-  Emplacement de stationnement, non clos ouvert sur la voirie
-  Noie
-  Limite de zone constructible des constructions annexes H.=5.00m maximum au faîtage
-  Limite de zone constructible de la construction principale H.=8.00m maximum au faîtage

NOTA

-  La direction du Nord est indicative
-  Les superficies ne deviendront définitives qu'après bornage des lots

DÉPARTEMENT DU GARD COMMUNE D'AUJARGUES Lieudit "Font de l'Aube et le Grand Jardin"

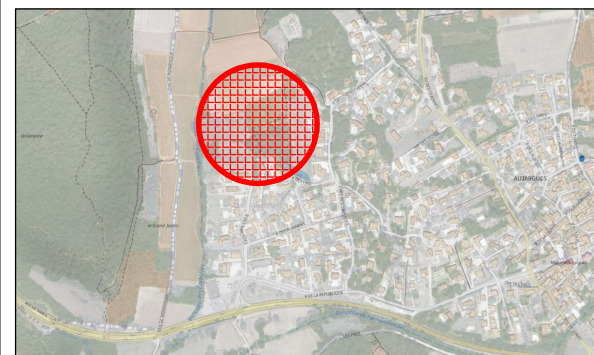

Plan de Situation

"Lotissement Le Grand Jardin"

Plan de Vente du lot 17 Échelle : 1/250

Références cadastrales :

Section : B

Superficie réelle : 416m²

Parcelle :

PROVISOIRE



Réf: 13557

Date : 24/07/2023
(date d'édition du tirage)



Dressé par :

Antoine VACHER
Géomètre Expert DPLG

250 chemin de Campagne
30250 SOMMIÈRES

Tél : 04 66 80 05 37
vacher.geometre@gmail.com

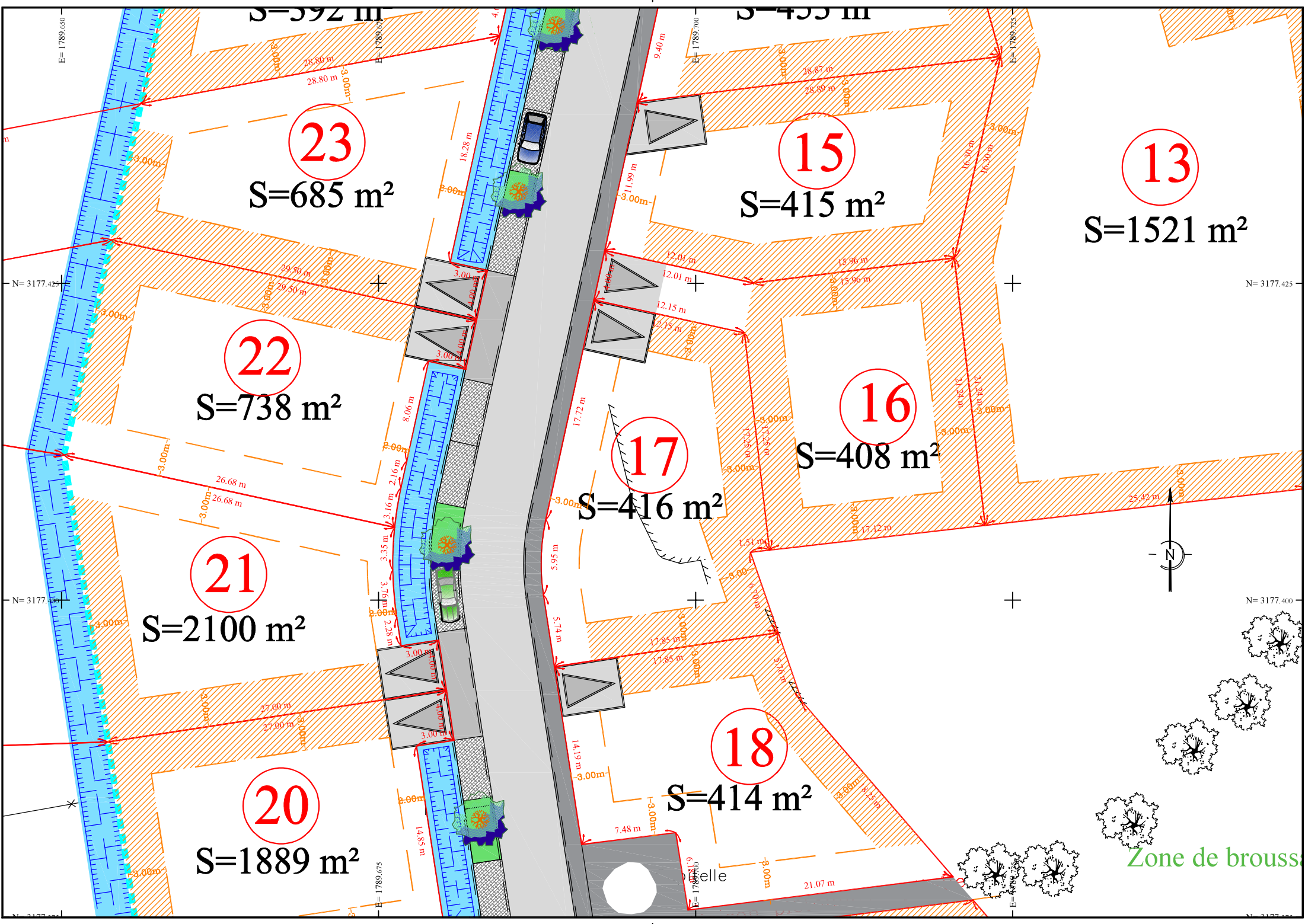

23

S=685 m²

15

S=415 m²

13

S=1521 m²

22

S=738 m²

16

S=408 m²

17

S=416 m²

21

S=2100 m²

18

S=414 m²

20

S=1889 m²

Zone de broussailles

